

Pressure and vacuum gauges

Pressure gauges

Pressure gauge DN 100 vertical connection with glycerin (1/2" BSP)

Page: 1/2

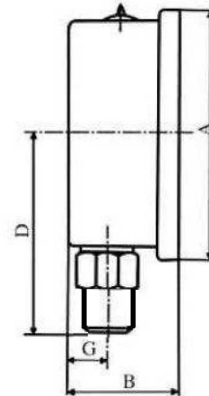
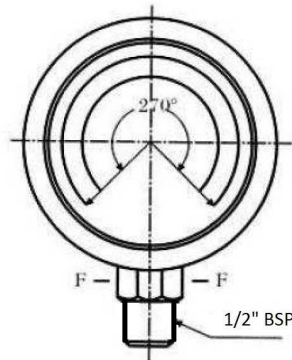

Accuracy: 1,6%

Dimensions: A=109
B=35,5
D=74
F=HEX 14
G=11,5

Temperature: from -20 up to +60

Material: Case: stainless steel 304
Ring: stainless steel 304
Window: polycarbonate (glass)
Socket & Connection: brass

Part n°	R1	Scale (bar)
MFI10008001V	1/2" BSP	0-1
MFI1000802.5V	1/2" BSP	0-2.5
MFI10008004V	1/2" BSP	0-4
MFI10008006V	1/2" BSP	0-6
MFI10008010V	1/2" BSP	0-10
MFI10008012V	1/2" BSP	0-12
MFI10008016V	1/2" BSP	0-16
MFI10008020V	1/2" BSP	0-20
MFI10008025V	1/2" BSP	0-25
MFI10008040V	1/2" BSP	0-40
MFI10008060V	1/2" BSP	0-60
MFI10008100V	1/2" BSP	0-100
MFI10008160V	1/2" BSP	0-160

Pressure and vacuum gauges

Pressure gauges

Pressure gauge DN 100 vertical connection with glycerin (1/2" BSP)

Page: 2/2

Part n°	R1	Scale (bar)
MFI10008250V	1/2" BSP	0-250
MFI10008315V	1/2" BSP	0-315
MFI10008400V	1/2" BSP	0-400
MFI10008600V	1/2" BSP	0-600
MFI100081000V	1/2" BSP	0-1000

*** Review attached PDF***

With dual bar/psi scale
IP65