

Pressure and vacuum gauges

Pressure gauges

Pressure gauge DN 100 vertical connection with glycerin (1/2" NPT)

Page: 1/1

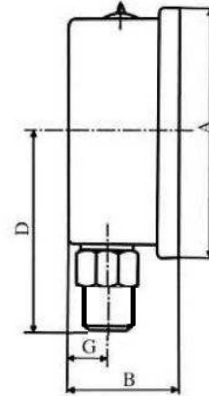
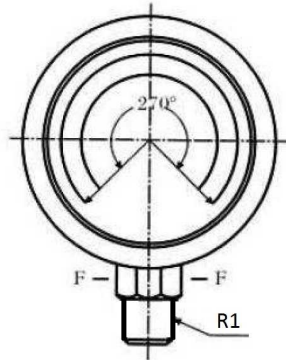

Accuracy: 1,6%

Dimensions: A=109
B=35,5
D=74
F=HEX 14
G=11,5

Temperature: from -20 up to +60

Material: Case: stainless steel 304
Ring: stainless steel 304
Window: polycarbonate (glass)
Socket & Connection: brass

Part n°	R1	Scale (bar)
MFI10008010V NPT	1/2" NPT	0-10
MFI10008025V NPT	1/2" NPT	0-25
MFI10008060V NPT	1/2" NPT	0-60
MFI10008250V NPT	1/2" NPT	0-250
MFI10008400V NPT	1/2" NPT	0-400
MFI10008600V NPT	1/2" NPT	0-600

*** Review attached PDF***
With dual bar/psi scale
IP65