

HMF HYDRAULIC CYLINDERS

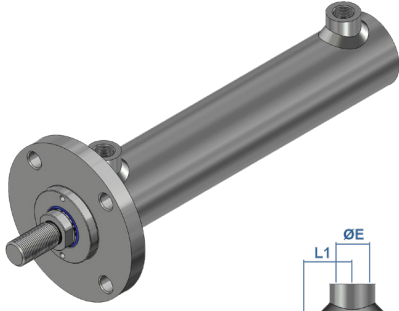

DOUBLE / SINGLE* ACTING HYDRAULIC CYLINDER (*=S/A WITH USE OF A BREATHER)

MAX PRESSURE = 210 BAR (CONTINUOUS) ► 250 BAR (INTERMITTENT)

MAX SPEED = 0.5 M/S

OPERATING TEMPERATURE (°C) = +80°C TO -25°C

TUBE MATERIAL = STEEL - ST52.3 - DIN2393 - ISO H9

ROD MATERIAL = STEEL - UNI C45 (SAE 1045) - 25 MICRON (±5) - EN8 GRADE

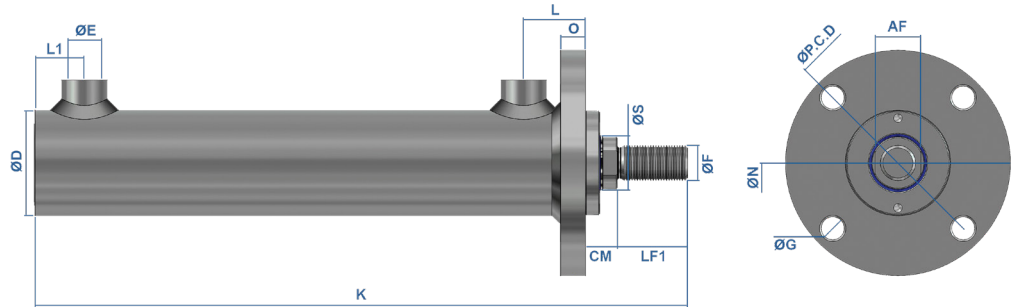

ORDER CODE	BORE Ø(mm)	D Ø(mm)	S Ø(mm)	K (mm)	STROKE (mm)	E Ø(bsp)	CM (mm)	L (mm)	L1 (mm)	F Ø(mm)	LF1 (mm)	O (mm)	AF (mm)	PCD Ø(mm)	N Ø(mm)	G (mm)	FLANGE REF	WEIGHT
HMF1200100	40	50	20	250	100	1/4"	18	32	25	16x1.5	30	12	18	87	109	11 (x4)	CFL0050	3
HMF1200200				350	200													3.8
HMF1200300				450	300													4.6
HMF1200400				550	400													5.4
HMF1200500				650	500													6.2
HMF2300100	50	60	30	270	100	3/8"	18	35	25	20x1.5	40	14	26	105	128	13 (x4)	CFL0060	4.6
HMF2300200				370	200													5.8
HMF2300300				470	300													7
HMF2300400				570	400													8.2
HMF2300500				670	500													9.4
HMF3350100	60	70	35	300	100	3/8"	20	40	30	27x2	50	16	32	117	142	13 (x4)	CFL0070	6.9
HMF3350200				400	200													8.4
HMF3350300				500	300													9.9
HMF3350400				600	400													11.4
HMF3350500				700	500													12.9
HMF4400100	70	80	40	312	100	3/8"	22	40	30	30x2	60	16	36	127	162	15 (x4)	CFL0080	8.63
HMF4400200				412	200													10.53
HMF4400300				512	300													12.76
HMF4400400				612	400													15
HMF4400500				712	500													17.2
HMF5500100	80	95	50	345	100	1/2"	25	50	40	36x2	70	18	45	149	181	17 (x6)	CFL0095	13.7
HMF5500200				445	200													16.8
HMF5500300				545	300													19.9
HMF5500400				645	400													23
HMF5500500				745	500													26.1
HMF6500100	100	115	50	375	100	1/2"	27	70	40	36x2	70	24	45	162	194	17 (x6)	CFL0115	20.2
HMF6500200				475	200													25.8
HMF6500300				575	300													27.2
HMF6500400				675	400													30.8
HMF6500500				775	500													34.4